

Toyota (Push to Start)

Avalon		13	14	15	16	17	18	
Camry	12	13	14	15	16	17		
Camry Hybrid	12	13	14	15	16	17		
Corolla			14	15	16	17	18	19
Prius C	12	13	14	15	16	17	18	
Rav 4 (Gas)		13	14	15	16	17	18	

-This remote start will monitor the vehicle lock circuit and use the pulses generated by pressing lock 3 times on your OEM remote to start the vehicle.

-This is a pre-wired kit. The ECU and Steering Lock connections are plug-in connections required for all covered vehicles.

-We have already loaded the correct firmware into the remote start module. You will need to pair the module to the vehicle when the installation is complete.

Step 1: Where Everything Goes

Remote Start Module – the wiring for the module is done under the dash on the driver’s side, so you’ll want to install the module in that general area. Before you start wiring, look for a location where there’s some open space that will fit the module. Pay attention to moving parts like the pedals, e-brake and steering column. Be sure to route your wiring away from those areas.

- Set the parking brake and without pressing the foot brake press the push to start button twice to turn the ignition on.
- Turn the steering wheel to the right to access a screw and remove the screw.
- Turn the steering wheel to the left to access the screw on the other side and remove the screw.
Use a plastic pry tool to separate the top and bottom half of the steering column cover.
- Pull the bottom cover down to separate the two halves.
- Turn the ignition off by pressing the push to start button one time. The steering lock connector is now accessible at underside of the steering column.
- Remove the side dash panel and lower dash panel. It should be held on by a few clips.
- Once the side panel is off make sure there are not any screws holding the lower dash panel on. Most vehicles do not have any screws - the front lower dash is secured by plastic clips. Gently pull the lower plastic panel and it will come unclipped.
- You will now see the ECU on the left side of the dash.

Connecting The T-Harness

Step 2: Steering Lock plug

Locate the Steering Lock Connector on the underside of the steering column. Remove the OEM plug from the vehicle and replace it with the plug on the T-harness. Insert the OEM plug in to the female receptacle on the T-harness.

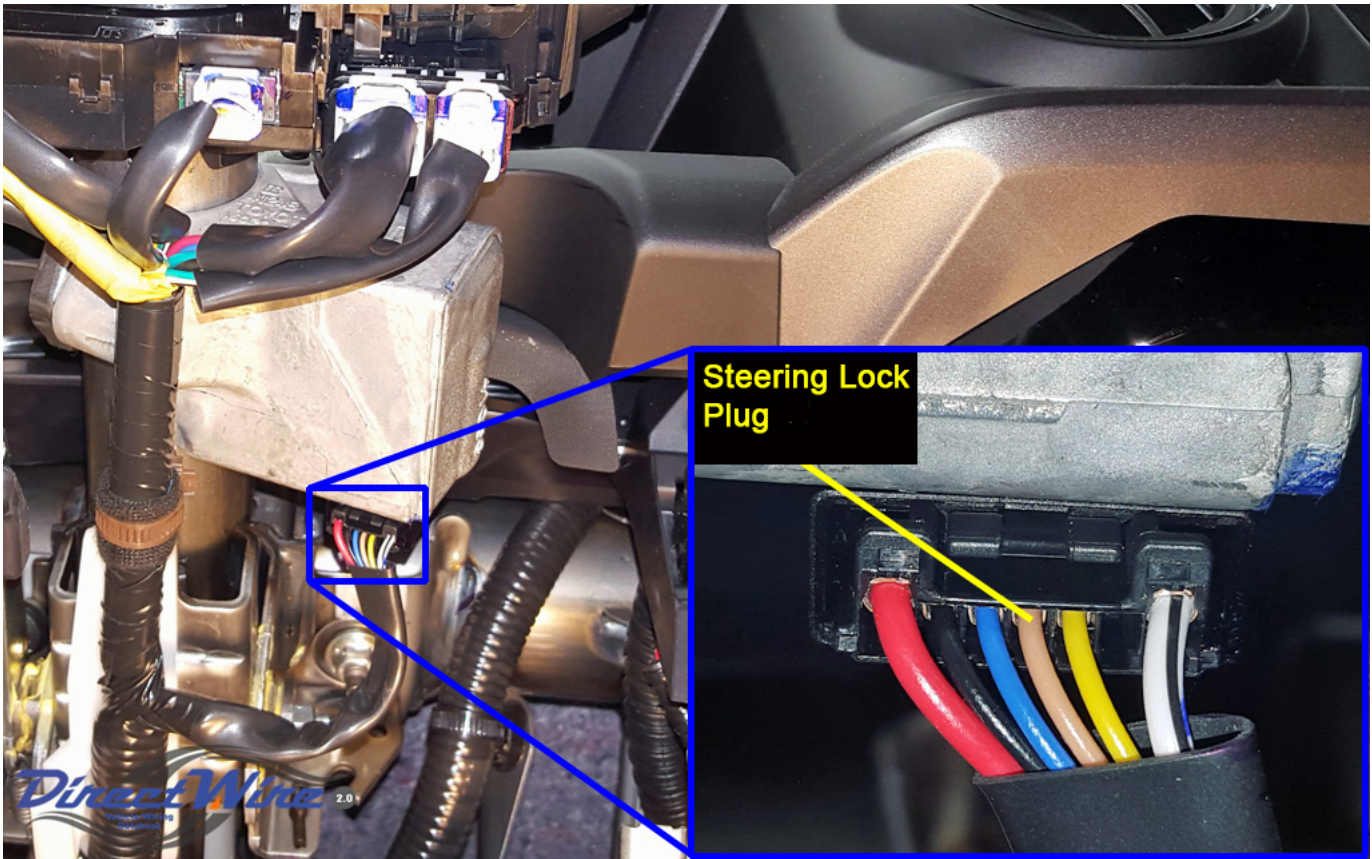

Step 3: ECU plug

The main body ECU is behind the dash on the left side. Locate the 30 pin plug on the ECU and unplug it from the ECU. Insert the male connector from the T-harness in to the vacated center position on the ECU. Insert the OEM plug in to the female receptacle on the T-harness.



System Wiring Diagram

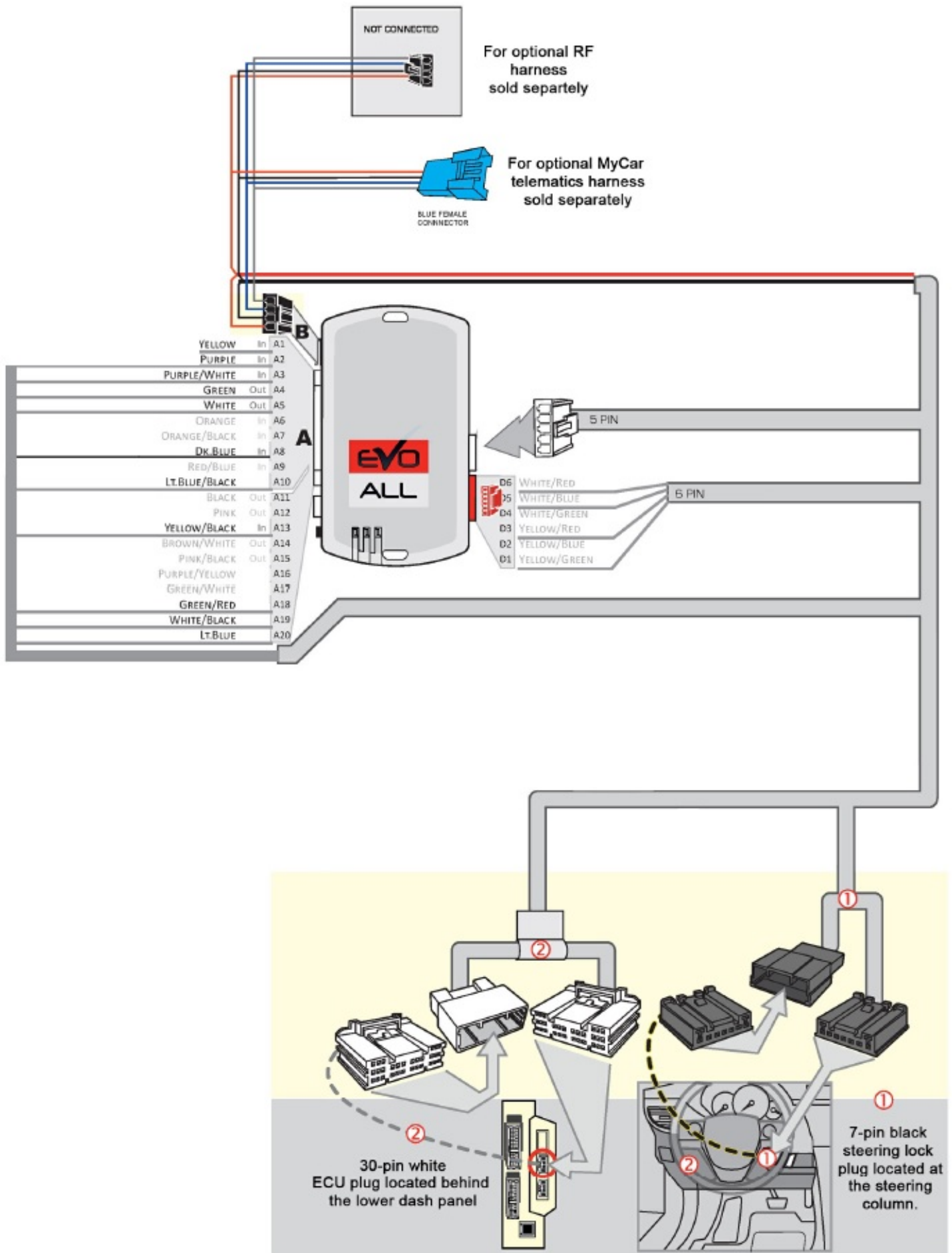

Step 4: Programming

1

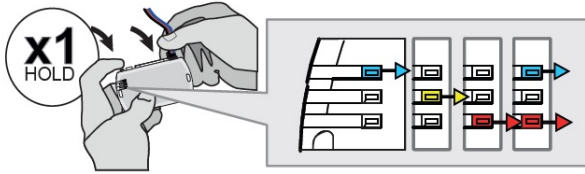

Press and hold the programming button:
Connect the 4-PIN Data-link connector.

↳ The BLUE, RED, YELLOW and BLUE & RED LEDs will alternatively illuminate.

2

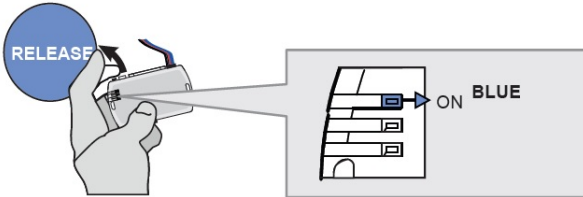

Release the programming button at the moment when the LED is BLUE.

If the LED does not remain solid BLUE after releasing the button, then **disconnect** the 4-Pin connector (Data-Link) and **go back** to step 1.

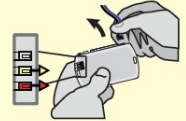

3

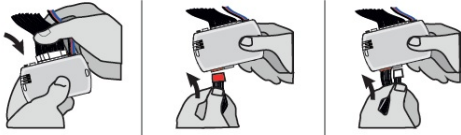

Insert the required remaining connectors.

4

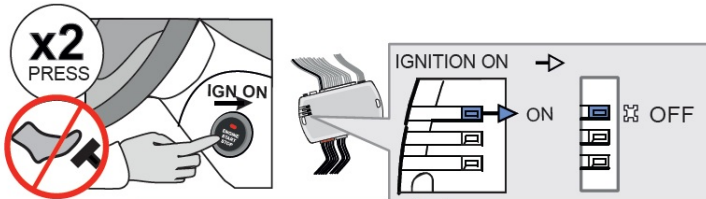

Do not press the brake pedal.
Press the Push-to-Start button twice to turn on the ignition.

↳ The BLUE LED should turn off.

OR

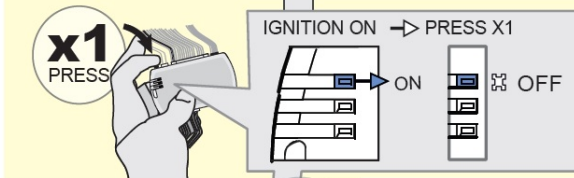

If the LED remains lit solid BLUE after the ignition is turned on, then **press and release** the programming button once (1x).

↳ The BLUE LED will turn off.

WAIT

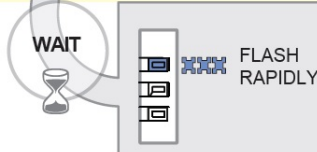

After the BLUE LED turns off, then **Wait**.

↳ The BLUE LED will flash rapidly.

5

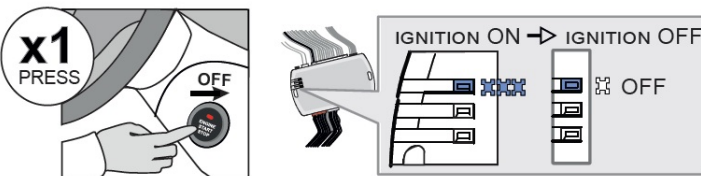

Press the Push-to-Start button once to turn off the ignition.

↳ The BLUE LED will turn off.



The module is now programmed.

Step 5: Test the System

1. Press "Lock>Lock>Lock" on your OEM remote control. You will see the Blue light on the remote start module every time you press the Lock button. Each press should be about 1 second apart. The vehicles ignition/accessory circuits will turn on after a few seconds. Another few seconds later the starter motor will engage.
2. Open the vehicle door. The remote start will shut down.

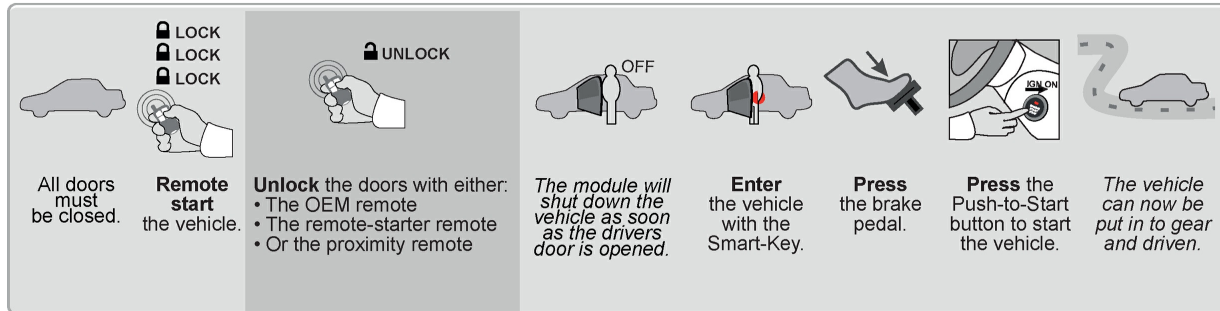

Step 6: Close it Up

Now gather up all of your wiring and neatly bundle it together using zip ties or electrical tape. Find a secure place to put the remote start module and use zip ties to secure it. **Make sure that the remote start wires are not near any moving parts on the steering wheel, pedals or emergency brake! Re-Install any panels that were removed to gain access to key switch in reverse order they were removed. Be careful not to pinch any wires. ENJOY!**

Parts List

- EVO-ALL Remote Start Data Module
- THAR-TOY6A T-Harness

If you have any installation questions or problems, call for tech support
520.579.1531